

**PHASING NOTES:**

PERVIOUS PARKING CONFIGURATION REFLECTS SAVINGS OF APPROX. 1/3 THE COST OF BASE/PAVEMENT/CURB & GUTTER.

SIMILAR REDUCTION MAY ALSO BE AVAILABLE IN STORMWATER MANAGEMENT COST BY REDUCED IMPERVIOUS SURFACE AND ASSOCIATED RUNOFF.

A PHASING SCENARIO MAY ENTAIL PAVING OF THE CENTRAL DRIVE AISLE TO SUPPORT THE HEAVIEST TRAFFIC CIRCULATION PATTERNS, THE DAILY USE STAFF PARKING AND HANDICAP ACCESSIBLE PARKING. THIS INFRASTRUCTURE COULD BE INSTALLED TOGETHER WITH THE FULL COMPLIMENT OF STRUCTURAL STORMWATER ELEMENTS REFLECTED IN THE LONG TERM PLAN, SO AS NOT TO LIMIT FUTURE EXPANSION ABILITIES AS FUNDING BECOMES AVAILABLE.

**NOTES:**

- ① STORMWATER MANAGEMENT AREA - SLIGHTLY REDUCED FROM MINIMIZED IMPERVIOUS SURFACE
- ② SLIGHTLY REDUCED RETAINING WALL HEIGHT AS RESULT OF REDUCED IMPERVIOUS SURFACE
- ③ PAVED PRINCIPAL CIRCULATION LANE
- ④ 48 PERVIOUS PARKING SPACES WITH TIMBER BUMPER BLOCKS FOR CONGREGATION/ EVENT PARKING
- ⑤ 10 PAVED PARKING SPACES FOR DAILY USE/STAFF PARKING, AND HANDICAP ACCESSIBLE PARKING

**POINT OF BEGINNING**  
 NORTHWEST CORNER OF LOT 11, BLOCK 72 OF JEFFERSON HEIGHTS SUBDIVISION TO BE RECORDED IN PLAT BOOK 51 PAGE 6 OF THE PUBLIC RECORDS OF JEFFERSON COUNTY, FLORIDA

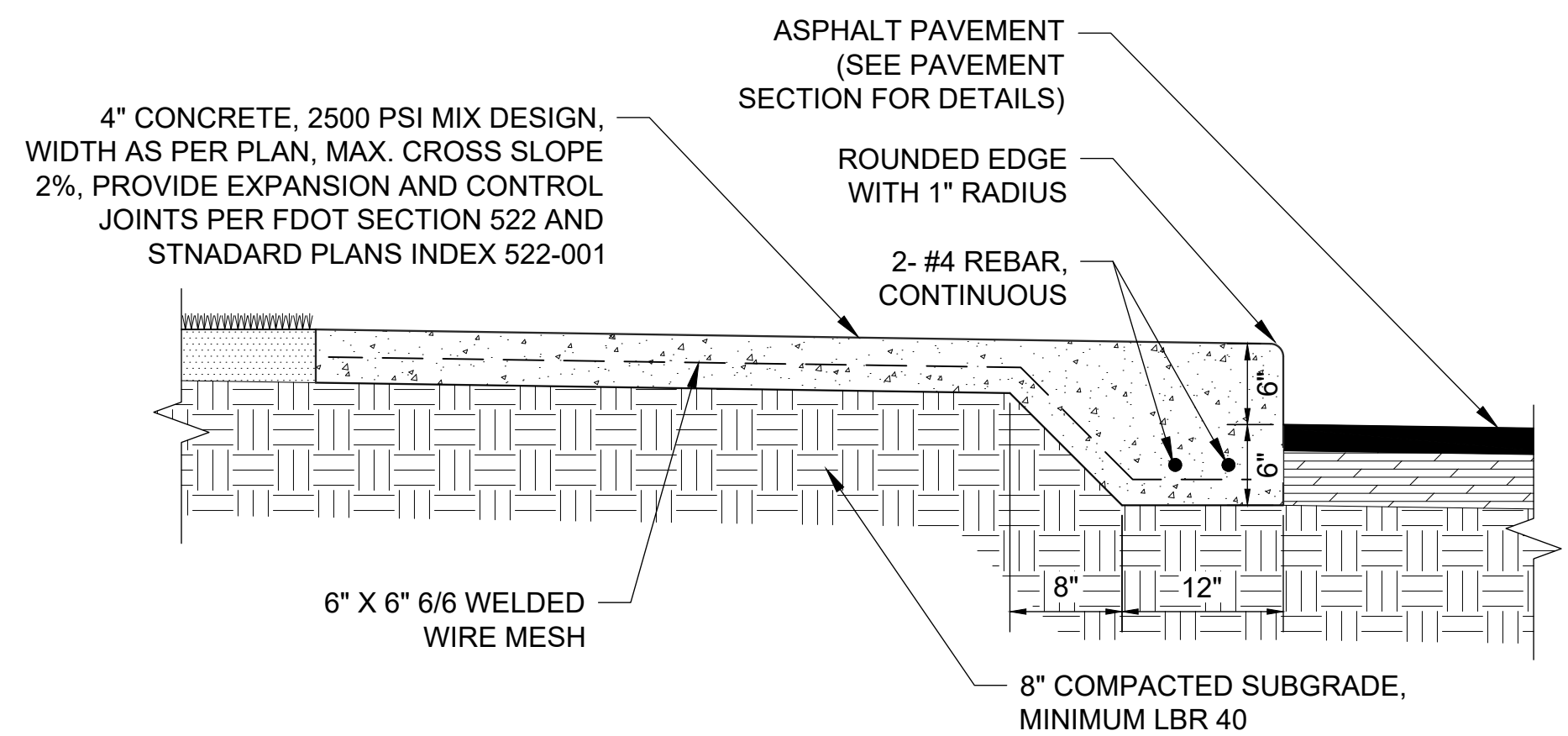
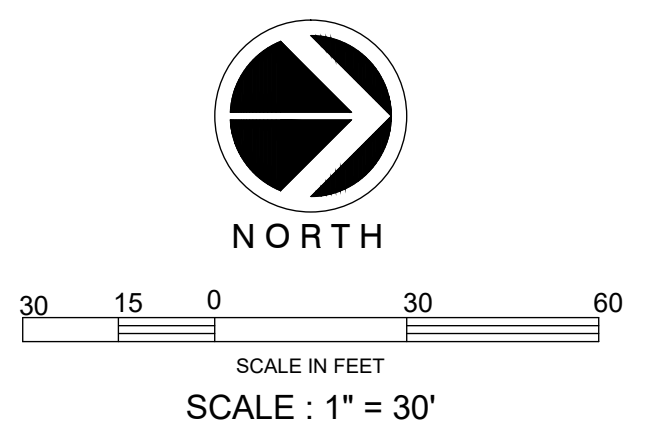

**Turned Down Sidewalk Detail**  
 Not To Scale

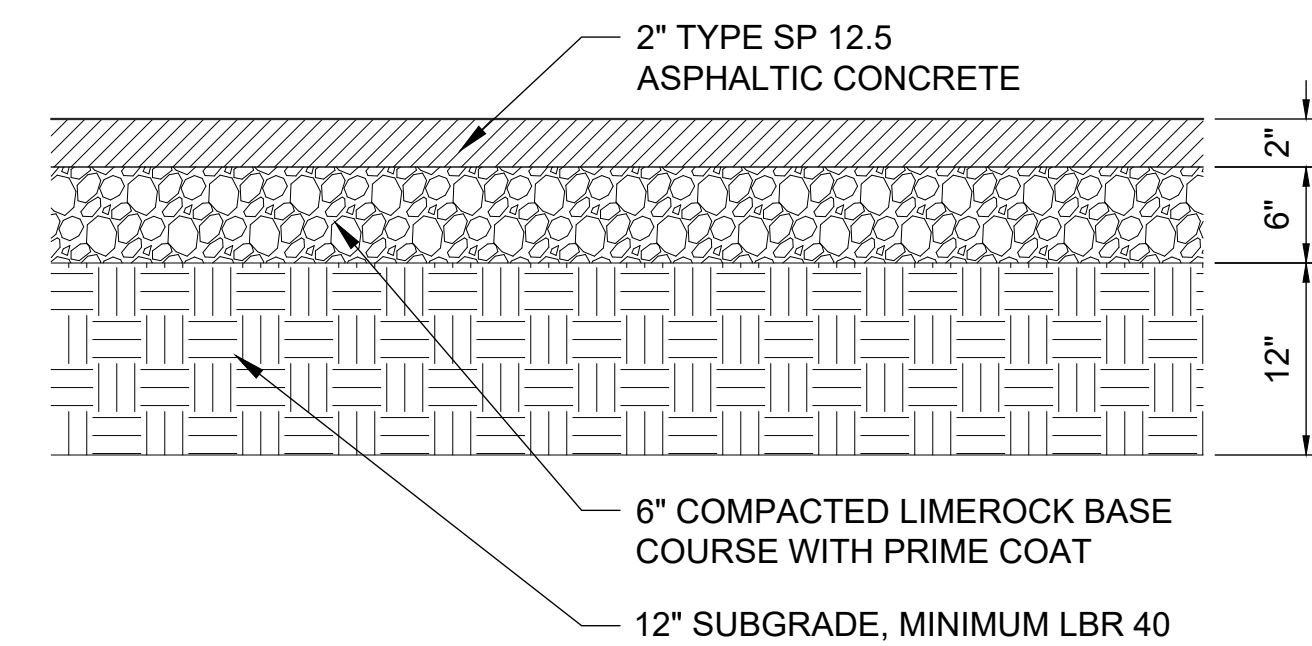

**Typical Asphalt Pavement Section**  
 Not To Scale

FILE NUMBER: 19-1216	EXTERNAL REFS: 1216-PLAN.DWG	REVISIONS:	DATE:
WORK ORDER: 1216			
DATE: 06/28/19			
SCALE: SHOWN			
FILE NAME: 1216-PLAN			
DESIGNED BY: CML			
DRAWN BY: CML/MMD			

**CLIFFORD LAMB & ASSOCIATES**  
 201 PINWOOD DRIVE TALLAHASSEE, FLORIDA 32303  
 CLIFFORD M. LAMB, P.E. TELEPHONE (850) 385-2800  
 FACSIMILE (850) 385-0483  
 CERTIFICATE OF AUTHORIZATION NO. 8876

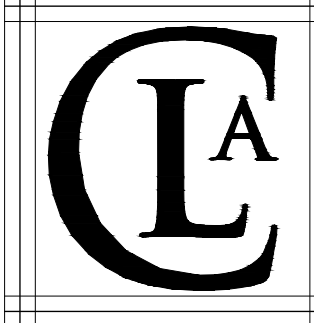

**RESTORED GLORY CHRISTIAN CENTER**  
 ELLIOT MARSHALL INNES, P.A.

**DIMENSIONAL SITE PLAN PLAN - ALTERNATE**

SEAL (NOT VALID UNLESS SIGNED AND EMBOSSED)  
**FOR REVIEW ONLY**  
 CLIFFORD M. LAMB P.E.  
 FL. REG. NO. 46644

SHEET NO.:  
**4 OF 4**